

INDUSTRIAL PRESSURE TRANSMITTER

Model: TPT01 (Standard)

Description

TPT01 series of pressure transmitters has been carefully designed to cover the majority of industrial applications with instruments. Compact design and robust construction make these instruments suitable for all application in machine construction, process control, laboratory or quality and materials testing equipment.

Application

- Mechanical Engineering Industry
- Hydraulic and level measurement
- Gas tank pressure monitoring
- Industrial test and control
- General industrial applications

Feature

- Various industrial standard signal output
- Various electrical connector available
- High accuracy, free of calibration
- Compact dimension design



Dimensions

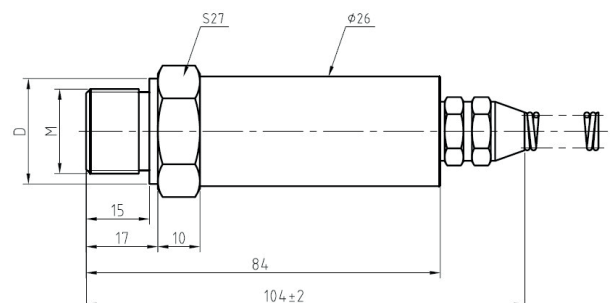
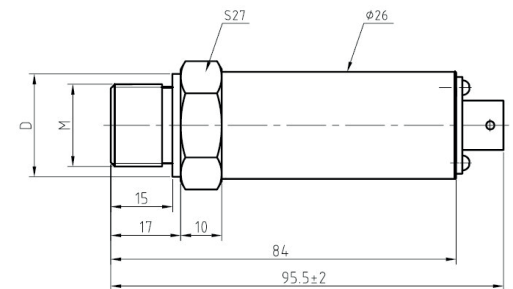
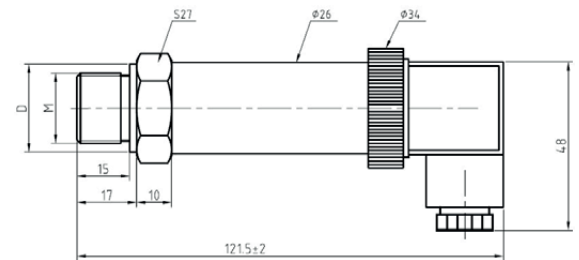

Specification

Range	-1-0-2000bar	
Accuracy	0.5%FS; 0.25%FS	
Thermal effect	0.02%FS/°C	
Long term stability	0.2%FS/year	
Output	4-20mA(Two wire), 0-5V, 0-10V(Three wire); 2mV/V, 3.3mV/V	
Input voltage	24(12-36)VDC (Amplify signal), 10(6-12)VDC (mV output)	
Operating Temperature	-20-100°C	
Compensated temperature	-10-70°C	
Overload pressure	150%FS	
Medium material	Stainless steel 304/316/316L, 17-4 PH, Titanium, PTFE, PVDF and etc.	
Electric connector	Hirschman (DIN) , M12,4pin, Bendix connector, grand cable (Customer design)	
Process connector	G1/4, G1/2, 1/2NPT, 1/4NPT, M12*1.5 (Customer design)	
Overload	150% FS	Burst: 200% FS

Electric Connector

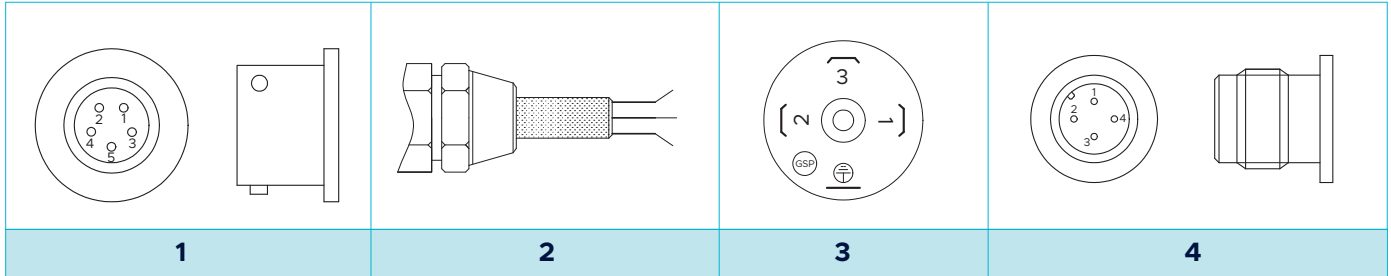

Electric Connection code							
Connector type1	Function	Color	5PIN	Connector type2	Function	Color	
5PIN connector 0-5V; 0-10V 0.5-4.5V,1-5V	S+	Blue	1	Grand cable 0-5V; 0-10V 0.5/4.5V,1-5V	S +	Blue	
	E+-	Red	2		E +	Red	
	E-/S-	Yellow/White	3		E-/S-	Yellow/White	
5PIN connector 1.5mV/V, 2mV/V 3.33mV/V	S+	Blue	1	Grand cable 1.5mV/V, 2mV/V 3.33mV/V	S+	Blue	
	E +	Red	2		E+	Red	
	S -	White	3		S -	White	
	E -	Yellow	4		E -	Yellow	
	C	Black	5		C	Black	
5PIN connector 4-20mA	E+	Red	1	Grand cable 4-20mA	E+	Red	
	S+	Black	2		S+	Black	
Connector type3	Function	Color	4PIN	Connector type4	Function	Color	4PIN
Hirschman 0-5V; 0-10V 0.5-4.5V,1-5V	E+	Red	1	M12x1 connector 0-5V; 0-10V 0.5-4.5V,1-5V	E +	Red	1
	S+	Blue	2		S +	Blue	3
	E -/S-	Yellow/White	3		E -/S-	White	4
Hirschman 4-20mA	E+	Red	1	M12x1 connector 4-20mA	E+	Red	1
	S+	Black	2		S+	Black	3

Ordering Guide

Model	Range	Output	Screw Thread	Connection	Other requirement
TPT01	---	---	---	---	---
Example : TPT01-50Bar-4/20mA-G1/2-Hirschman					

Remarks:

Please connect the pressure transmitter with the opposite connection for difference electric connector. If the pressure transmitters with cable, please refer to the right color.