

Mini Pneumatic Piston Valves (3/8", 1/2", 3/4") PP1030 Series

Application Areas

Water, Air, Vapour, Gas, Chemicals, Petrol Products, Food, Pharmaceutical, Sterilized Environment, Refining, Dye Machines, Packaging Machines, Drinking Water Station, Vacuum Applications, Oil, Petrol, Alcohol, Hydraulic Oil, Salt Water, Natural Gas, Acid

Technical Features

Opening Closing Time	: 30-40 ms
Fluid Viscosity	: Max. 600 mm ² /s
Actuator Material	: Fiber glass reinforced poliamid (PAGF30)
Positioner and Switch Bos	: Connectable
Connection Type	: Threaded or Flanged
Control Valve	: 3/2 way TORK Solenoid Valve
Montage Way	: Flow must be in the direction of the arrow on the body
Body	: Whole stainless steel body

A newly developed sealing and bearing material is used in the mini-piston valves. Thanks to this new development, the product is able to work long time smoothly.

One of the issues to be considered in this product is that the flow direction is opposite according to other piston valves.

Opposite flow direction prevents the leakage of the fluid by the pressure in the inlet pushes the plunger. The problem of leakage with the increase of the inlet pressure is a problem that is constantly encountered in other piston valves. However, this time, if the flow pressure is too high, the problem of the piston spring does not close the orifice arises. For this reason, the product is not suitable to work at more than 16 bar.

NORMALLY CLOSED

- ECONOMIC, LIGHT AND USEFUL
- LESS AIR CONSUMPTION

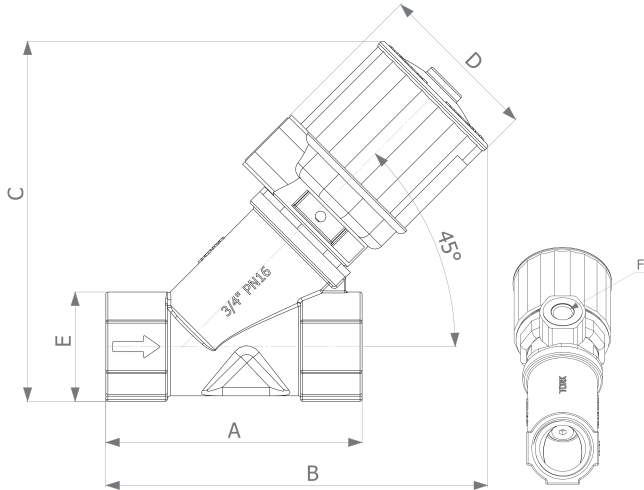
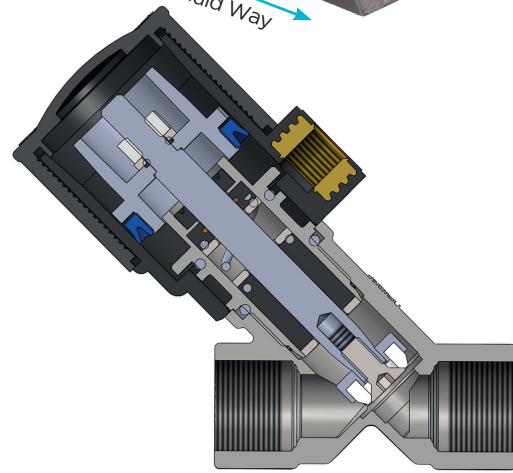
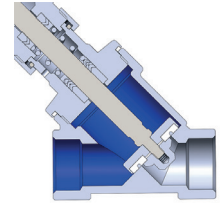

Valve Type/ Order No	DIN		A	B	C	D	E	F
	mm	G	mm	mm	mm	mm	mm	G
PP1030.02	10	3/8"	80	104	95	49	26	1/8"
PP1030.03	15	1/2"	62	104	95	49	26	1/8"
PP1030.04	20	3/4"	75	113	104	49	32	1/8"

Valve Type/ Order No	Connection Size	Orifice Pressure	Working Pressure		Pilot Pressure		Control Cylinder	Kv	Fluid Temperature		Seal	Weight
			Bar	Bar	Bar	Bar			°C	°C		
PP1030	G"	mm	Min	Max	Min	Max	Ø	Lt/dak	Min	Max		Kg
PP1030.02	3/8"	12	-1	16	4	8	31	25	-20	110	PTFE	0,41
PP1030.03	1/2"	12	-1	16	4	8	31	45	-20	110	PTFE	0,35
PP1030.04	3/4"	17	-1	13	6	8	31	90	-20	110	PTFE	0,48

* The maximum working pressure in the tables is given according to the pilot pressure of 6 bar.